



使用说明书

Instructions for use

个人装备：救援、攀登、绳索、器材专业制造商

Professional manufacturer of industrial, outdoor, rope, equipment



Made in China
Hangzhou City, Zhejiang Province, China
3507, Xinghui Center, No. 723 Dayuan Road, Lin'an District, Hangzhou City, Zhejiang Province, China
杭州市临安区天目山路723号星汇中心5507
Tel: 0086-571-61077751 Fax: 0086-571-61077752
E-mail: sales@hoater.com Web: www.hoater.com
HOATER (Hangzhou) Safety Technology Co., Ltd.
霍安纳(杭州)安全技术有限公司

ENGLISH

Applic to Anchor kit: HT-MD03/HT-MD04

Manufacturer: HOATER (Hangzhou) Safety Technology Co., Ltd.
3507, Xinghui Center, No. 723 Dayuan Road, Lin'an District, Hangzhou City, Zhejiang Province, China

Certified body: VVUÚ a.s (n°1019) Pikartská 1337/7, Ostrava-Radvanice, 716 07, Czech Republic

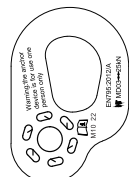

HT-MD03-A

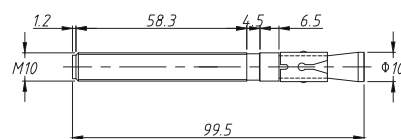

HT-MD03-B



HT-MD04-A

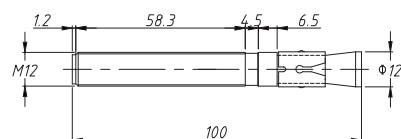

HT-MD04-B

The use of HT-MD03/HT-MD04 anchor kit is intended for mountaineering, climbing and related activities for protection against falls from height. This product meet European Standard EN 795: 2012 type A , EN959:2018 and UIAA123.

If the product is re-sold outside the original country of destination the reseller shall provide instructions for use, for maintenance, for periodic examination and for repair in the language of the country in which the product is to be used.

SUITABLE ENVIRONMENT

For anchor installations on a sea cliff, or in any other highly corrosive environment, the lifetime of the anchor is significantly reduced. It is preferable to use a material with a corrosion resistance suitable for harsh environments that cause stress corrosion cracking, so that the lifetime of the installation is satisfactory.

LIMITATIONS

Consider the following application limitations before using this equipment:

- 1.The equipment shall not be used outside its limitations, or for any purpose other than that for which it is intended.
- 2.The product should only be used by trained and/or otherwise competent persons or the user should be under the direct supervision of a trained and/or competent person.
- 3.No more than one personal protective system may be connected at one time.
- 4.During the use, User use equipment must under supervision.
- 5.Ensure compatibility of all other products used with the equipment when assembled into a system.
- 6.The user should carry out a pre-use check of the equipment, to ensure that it is in a serviceable condition and operates correctly before it is used.
- 7.Dangers May arise by use of combinations of items of equipment in which the safe function of any one item is affected by or interferes with the safe functions of another. Ensure the compatibility of items of equipment when assembled into a system;
- 8.That the anchor device should only be used for personal fall protection equipment and not for lifting equipment.
9. The anchor device is for use of one person only.

Additional information

- This anchor device class A was tested according to the norm EN 795 for use by only one person. When the anchor device is used as part of a fall arrest

system, the user must be equipped with a means to limit the maximum dynamic forces exerted on them during the arrest of a fall with a maximum of 6 kN.

- The maximum load that can be transmitted to the structure by the anchor is approximately 12 kN.
- You must have a rescue plan and the means to rapidly implement it in case of difficulties encountered while using this equipment.
- The anchor point for the system should preferably be located above the user' s position and should meet the requirements of the EN 795 standard (12 kN minimum strength).
- In a fall arrest system, it is essential to check the required clearance below the user before each use, in order to avoid hitting the ground or an obstacle in the event of a fall.
- Make sure that the anchor point is correctly positioned, in order to limit the risk and the length of a fall.
- A fall arrest harness is the only device allowable for supporting the body in a fall arrest system.
- When using multiple items of equipment, a dangerous situation can arise in which the safety function of an item of equipment can be affected by the safety function of another item of equipment.
- **WARNING - DANGER:** ensure that your products do not rub against abrasive or sharp surfaces.
- Users must be medically fit for activities at height. **WARNING:** inert suspension in a harness can result in serious injury or death.
- Make sure the markings on the product are legible.

IMPORTANT

- avoid direct connections with textile devices;
- always use the components supplied in the device;
- it may be appropriate carrying out trial installations of rock anchors in a range of different lengths, in typical rock, and testing the load-bearing capacity in situ;
- load-bearing capacities cannot be guaranteed if the material is less strong or less homogeneous than the concrete block specified (e.g.unconsolidated material, micro fissures, hollow/air pockets), and insuch cases it may be necessary to use a rock anchor of greater length(perhaps a much greater length), or even of a different construction;
- the position of the anchor is fundamental for arresting a fall safely:carefully assess the clearance under the user, the height of a potentialfall, the stretch of the line/rope, the deployment of an eventual energyabsorber, the height of the user, and the "pendulum" effect, in order toavoid any possible obstacle (eg the ground, the rubbing, abrasions,etc.).

WARNING

Activities involving the use of this equipment are inherently dangerous. You are responsible for your own actions, decisions and safety. Before using this equipment, you must:

- Read and understand all Instructions for Use.
 - Get specific training in its proper use.
 - Become acquainted with its capabilities and limitations.
 - Understand and accept the risks involved.
- Failure to heed any of these warnings may result in severe injury or death. This product must only be used by competent and responsible persons, or those placed under the direct and visual control of a competent and responsible person.
- You are responsible for your actions, your decisions and your safety and you assume the consequences of same. If you are not able, or not in a position to assume this responsibility, or if you do not fully understand the Instructions for Use, do not use this equipment.

WITHDRAWN FROM USE

WARNING: an exceptional event can lead you to retire a product after only one use, depending on the type and intensity of usage and the environment of usage (harsh environments, marine environments, sharp edges, extreme temperatures, chemicals ...).

- A product must be removed and retired when:
- It has been subjected to a major fall or load.
 - It fails to pass inspection. You have any doubt as to its reliability.
 - You do not know its full usage history.
 - When it becomes obsolete due to changes in legislation, standards, technique or incompatibility with other equipment...
- Destroy these products to prevent further use.

RESPONSIBILITY

The manufacturer or the distributor, will not accept any responsibility for damage, injury or death resulting from misuse of or from modifications to our products. It is the user's responsibility at all times to ensure that he/she understands the correct and safe use of any equipment supplied by or from

the manufacturer, that he/she uses it only for the purposes for which it is designed and that he/she practices all proper safety procedures. Before using the equipment, take all necessary steps to familiarise yourself with rescue techniques should an emergency occur. You personally assume all the risks and responsibilities for your actions and decisions: if you are not able or not in a position to assume these, do not use this equipment.

INSPECT

Your safety depends upon the integrity of your equipment. We recommends a detailed inspection by a competent person at least once every 12 months (depending on current regulations in your country, and your conditions of usage).
Warning: your intensity of use may cause you to inspect your PPE more frequently. Follow the EQUIPMENT RECORD sheet to record the information. It is recommended that you write the next inspection date on your product. Before each use Check the condition of the anchor: surface degradation, wear, corrosion, deformation, cracks.
During use It is important to regularly monitor the condition of the product and its connections to the other equipment in the system. Make sure that all items of equipment are correctly positioned with respect to each other. Regular inspection of the installation is recommended, in order to detect possible corrosion. Near the sea or in a corrosive environment, inspect more frequently.

HOW TO INSTALL THE ANCHOR

Before installation, verify that the hanger and its means of attachment to the supporting medium (e.g. the bolt) are made of the same material. Example of installation with an expansion bolt: Check the quality of the supporting medium around the anchor. Make sure the rock is solid and uniform.
a. After cleaning the drilling area of any friable rock, drill a hole of the appropriate diameter and depth, and clean the hole.
b. Push the bolt with the hanger into the hole and tighten the nut to the recommended torque.
c. After each installation, verify that the quick draw moves freely in the hanger. **Warning:** if the bolt protrudes too much, it can hinder free movement of the quick draw in the bolt hanger.

Hanger removal:

Unscrew the nut and remove the hanger. Before reusing the hanger, carry out a detailed inspection of it. Recommend on adhesives for the installation of glue-in anchors, that give adequate strength and have a long in use lifespan;

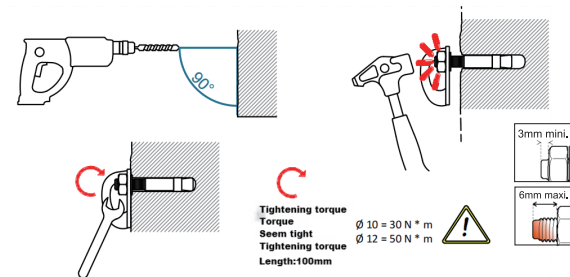

Warning

- Immediately retire the devices if:
- it fails to pass inspection,
 - it has been subjected to a major fall or load,
 - you do not know its full usage history, - it is non conforming to updated norms, not suitable or compatible to the present techniques,
 - you have any doubts as to its integrity. To prevent future use, destroy retired equipment.
- When suspect that the product is no more safety and reliable, please contact the manufacturer or the distributor.

How to use the anchor device

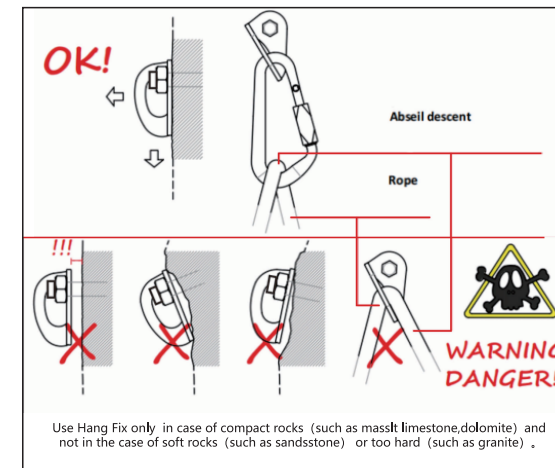

Recommendation on adhesives for the installation of glue-in anchors, that give adequate strength and have a long in use lifespan. **Warning:** that the rock anchor can have a lower load-bearing capacity when installed in soft rock .

MAINTENANCE

Carefully clean and dry it to remove all dirt or foreign material and moisture. Minor sharp edges may be smoothed with a fine abrasive cloth, before cleaning. Store in a clean, dry place.

LIFETIME:

3-year guarantee Against any material or manufacturing defect. Exclusions: normal wear and tear, oxidation, modifications or alterations, incorrect storage, poor maintenance, negligence, uses for which this product is not designed.

STORAGE AND TRANSPORT

Store the device in a dry place (relative humidity 40-90%), fresh (temperature 5-30 ° C) and dark, chemically neutral (avoid absolutely saline and / or acid environments), away from sharp edges, corrosive substances or other possible prejudicial conditions. Transport the device considering the precautions foreseen for storage and limit direct exposure to sunlight and moisture.

PPE marking

These products is marked with:

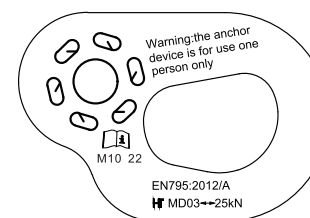

"HOATER" means manufacture' s brand. HT-MD03/HT-MD04 means model number; **Warning:**The anchor device is for use of one person only. Means the Axial load bearing capacity; Means the radial load bearing capacity;

XX/YY: means batch number (XX express month, YY express year.) EN795:2012/A: means European standard and public year, Class A means the type of anchor device

EN959:2018: means European standard and public year. Class of rock anchor in EN959:2018 standards on mountaineering equipment. Means "Always read and follow the warnings and instructions for use"

Appendix

Rock anchors in accordance with this document, when installed in accordance with the manufacturer's instructions. It can should provide at least the axial load-bearing capacities :15kN, radial load-bearing capacities:25kN, belay rock anchor linking elements: 25kN. However, these load-bearing capacities cannot be guaranteed if the rock, into which the anchor is installed, is less strong or lesshomogeneous than the concrete block minimum dimensions of 200mm x 200mm x 200mm and a compressive strength of (50 ± 10)N/mm² and the maximum grain size of aggregate shall not exceed 16mm and the compressive strength of the concrete lock shall be verified on three test samples produced as specified in ISO 1920-3. Examples of such inhomogeneities are regions of unconsolidated material, micro fissures and hollow/ air pockets. In such cases, to achieve the required load-bearing capacity, it may be necessary to use a rock anchor of greater length(perhaps a much greater length), or even of a different construction. The manufacturer needs to provide information (Recommend on adhesives for the installation of glue-in anchors, that give adequate strength and have a long in use lifespan) of this document to make the installer aware of these potential problems and suggest possible courses of preventative action. Some designs of rock anchor may not be suitable for installation in certain types of rock. In other cases it may be appropriate to recommend carrying out trial installations of rock anchors in a range of different lengths, in typical rock, and testing the load-bearing capacity in situ.

Record

Keep a record for each products.



